

AIRCONCEPTS

AIR DISTRIBUTION PRODUCTS



SDR-LI SERIES

SDR-LI

Swirl Diffuser - Round Panel

Swirl Diffuser Dimensions in Inches

MODEL	B	D	H
SDR-06-LI	1 3/16	6	2
SDR-08-LI	1 3/16	8	2
SDR-10-LI	1	10	2
SDR-12-LI	1	12	2
SDR-14-LI	1 1/2	14	2 1/2
SDR-16-LI	1 3/8	16	2 1/2

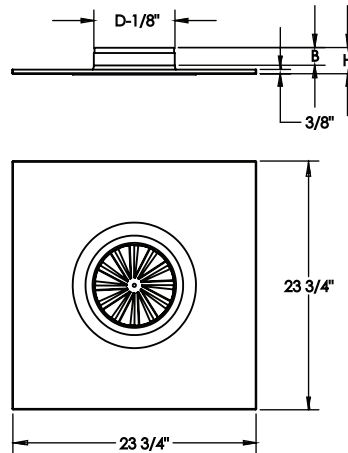

High Velocity/ High Aspiration Air Outlet

- Swirl pattern design
- Lay-in panel
- Easy installation

Construction

- Heavy gauge aluminum face

Finishes

- Standard: #52 White powder coat
- Optional standard: #00 Mill
- #12 Anodized powder coat
- #42 Gloss black powder coat
- #43 Flat black powder coat finish
- #62 Grey prime powder coat
- #72 Silver metallic powder coat
- Custom colors available

MODEL	Duct Velocity Velocity Pressure	400 0.010	500 0.016	600 0.022	700 0.031	800 0.040	900 0.051	1000 0.062
SDR-06-LI	CFM	78	98	118	137	157	176	196
	Static Pressure	0.11	0.17	0.24	0.33	0.43	0.54	0.66
	NC	21	26	30	35	38	41	44
	Radius of Diffusion	1-2-4	2-3-6	2-4-7	3-4-7	3-5-10	4-6-11	4-6-12
SDR-08-LI	CFM	140	175	209	244	279	314	349
	Static Pressure	0.09	0.14	0.20	0.27	0.35	0.44	0.55
	NC	21	26	30	35	38	41	44
	Radius of Diffusion	2-3-6	3-4-8	3-5-10	4-6-11	4-7-13	5-8-15	6-8-16
SDR-10-LI	CFM	218	273	327	382	436	491	545
	Static Pressure	0.08	0.11	0.18	0.22	0.32	0.36	0.49
	NC	22	27	32	36	39	42	45
	Radius of Diffusion	3-4-8	3-5-10	4-6-12	5-7-14	6-9-17	6-9-18	7-10-20
SDR-12-LI	CFM	314	393	471	550	628	707	785
	Static Pressure	0.08	0.11	0.18	0.22	0.32	0.36	0.49
	NC	22	27	32	36	39	42	45
	Radius of Diffusion	3-5-10	4-6-12	5-8-15	6-9-17	7-10-20	7-11-22	8-12-24
SDR-14-LI	CFM	428	535	641	748	855	962	1069
	Static Pressure	0.08	0.11	0.18	0.22	0.32	0.36	0.49
	NC	22	27	32	36	39	42	45
	Radius of Diffusion	4-6-12	5-7-14	6-9-17	7-10-20	8-12-23	9-13-26	10-14-28
SDR-16-LI	CFM	558	698	838	977	1117	1256	1396
	Static Pressure	0.08	0.11	0.18	0.22	0.32	0.36	0.49
	NC	23	28	33	37	40	43	46
	Radius of Diffusion	4-7-14	5-8-16	7-10-19	8-12-23	9-14-26	10-16-29	11-18-32

RADIUS OF DIFFUSION: Horizontal distance (THROW) in feet from the Diffuser at which the maximum velocity has been reduced to specified terminal velocity (Vt).

TERMINAL VELOCITY: Maximum velocity (Vt) in feet per minute at the specified distance from the outlet face (THROW) 150 fpm, 100 fpm and 50 fpm respectively.

AIRFLOW CFM: Standard air density and isothermal conditions.

STATIC PRESSURE: Inches of water gauge required.

Performance data based on ASHRAE 70-06

NOISE CRITERIA: Noise criteria (NC) curve which is not exceeded with a Room Attenuation of 10db and based on Sound Power Level Re: 10-12 watts.