

Aluminum Punkah Louver - Round Duct Series

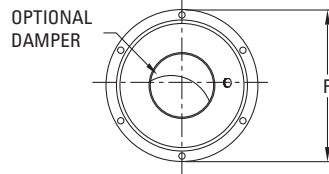

(Shown w/ aperture damper)

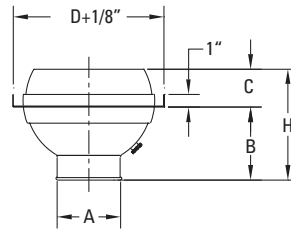

HIGH VELOCITY TASK AIR OUTLET

- Low Noise Levels
- Low Pressure Requirements

ADJUSTABILITY

- Easy Finger Tip Adjustment
- Directional Air Pattern Control:
70 Degree Global Rotation Minimum
±35 Degree Deflection
360 Degree Rotation

INSTALLATION

- Mounts Cleanly to Exposed Ductwork

MODEL	Size	A	B	C	D	F	H
APL-04 / 04A-RD	4	2	2-9/16	3/4	6	6	3-5/16
APL-06 / 06A-RD	6	3	3-1/16	1-7/16	8	8	4-1/2
APL-08 / 08A-RD	8	4-3/8	4-1/4	1-3/4	10	10	6
APL-10 / 10A-RD	10	5-3/4	5-1/2	2-7/8	12	12	8-3/8
APL-12 / 12A-RD	12	7-3/8	6	3	14	14	9
APL-14 / 14A-RD	14	8-5/8	7-1/8	4-1/8	16	16	11-1/4
APL-16 / 16A-RD	16	9-3/4	8-1/4	4-3/4	18	18	13
APL-18 / 18A-RD	18	10-1/2	9-1/2	4-1/4	20	20	13-3/4
APL-20 / 20A-RD	20	12-3/8	10-7/8	4-7/8	22	22	15-3/4

(Inches measured to the nearest 1/16")

Standard Material

- Heavy Gauge Aluminum
- Stainless Steel Damper Hardware

Notes

- Mounting Screws Included
- Frame Slides Cleanly Over End of Exposed Ductwork
- "A" in Model Name Designates Aperture Damper

Options

- Aperture Damper

Standard Finishes

- #00 mill
- #10 clear anodized
- #12 anodized powder coat
- #42 gloss black powder coat
- #43 flat black powder coat
- #52 white powder coat
- #62 grey primer powder coat (on field painting)
- #72 silver metallic powder coat
- #99 custom color / color match (paint chip needed)

Project :	<h2>APL Series</h2> <p>Aluminum Punkah Louver - Round Duct Series</p>	
Architect :		
Engineer :		
Contractor :		
Submitted By :	Date :	Form # : 20013S
		Drawn By : MH September 2005