

## Aluminum Punkah Louver - Round Reducer Series

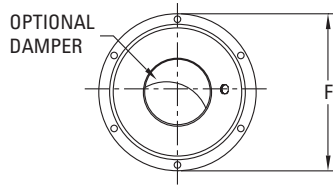

(Shown w/ aperture damper)

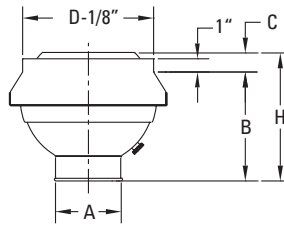

### HIGH VELOCITY TASK AIR OUTLET

- Low Noise Levels
- Low Pressure Requirements

### ADJUSTABILITY

- Easy Finger Tip Adjustment
- Directional Air Pattern Control:  
70 Degree Global Rotation Minimum  
±35 Degree Deflection  
360 Degree Rotation

### INSTALLATION

- Mounts Cleanly to Exposed Ductwork

MODEL	Size	A	B	C	D	F	H
APL-06 / 06A-RR	6	3	5-9/16	1	6	8	6-9/16
APL-08 / 08A-RR	8	4-3/8	6-3/4	1	8	10	7-3/4
APL-10 / 10A-RR	10	5-3/4	8	1	10	12	9
APL-12 / 12A-RR	12	7-3/8	8-1/2	1	12	14	9-1/2
APL-14 / 14A-RR	14	8-5/8	9-5/8	1-5/8	14	16	11-1/4
APL-16 / 16A-RR	16	9-3/4	10-3/4	2-1/4	16	18	13
APL-18 / 18A-RR	18	10-1/2	12	1-3/4	18	20	13-3/4
APL-20 / 20A-RR	20	12-3/8	13-3/8	2-3/8	20	22	15-3/4

(Inches measured to the nearest 1/16")

### Standard Material

- Heavy Gauge Aluminum
- Stainless Steel Damper Hardware

### Notes

- Mounting Screws Included
- Frame Slides Cleanly Into End of Exposed Ductwork
- "A" in Model Name Designates Aperture Damper

### Options

- Aperture Damper

### Standard Finishes

- #00 mill
- #10 clear anodized
- #12 anodized powder coat
- #42 gloss black powder coat
- #43 flat black powder coat
- #52 white powder coat
- #62 grey primer powder coat (on field painting)
- #72 silver metallic powder coat
- #99 custom color / color match (paint chip needed)

<b>Project :</b>	<h2>APL Series</h2> <p>Aluminum Punkah Louver - Round Reducer Series</p>	
<b>Architect :</b>		
<b>Engineer :</b>		
<b>Contractor :</b>		
<b>Submitted By :</b>	<b>Date :</b>	<b>Form # : 20014S</b>
		<b>Drawn By : MH January 2005</b>